



EVIDENCE OF
PREVIOUS LOCK
TO RIVERBANK SCRUB AND
AND INFORMATION MATURE TREES.
BOARD.

RECENT
WORK BY
THE HANDLE
TRUST.

DALE PARK - EXISTING



SCRUB CLEARED
TO IMPROVE
ACCESS

EXISTING TIERED
AREA USED TO
CREATE BACKWATER

TIEBOARDS
COULD BE
REMOVED / GOALS
BUILT OUT
TO CONNECT WITH
RECENT REHAB
PROJECT

HACK BRIDGE



DALE PARK - PROPOSED

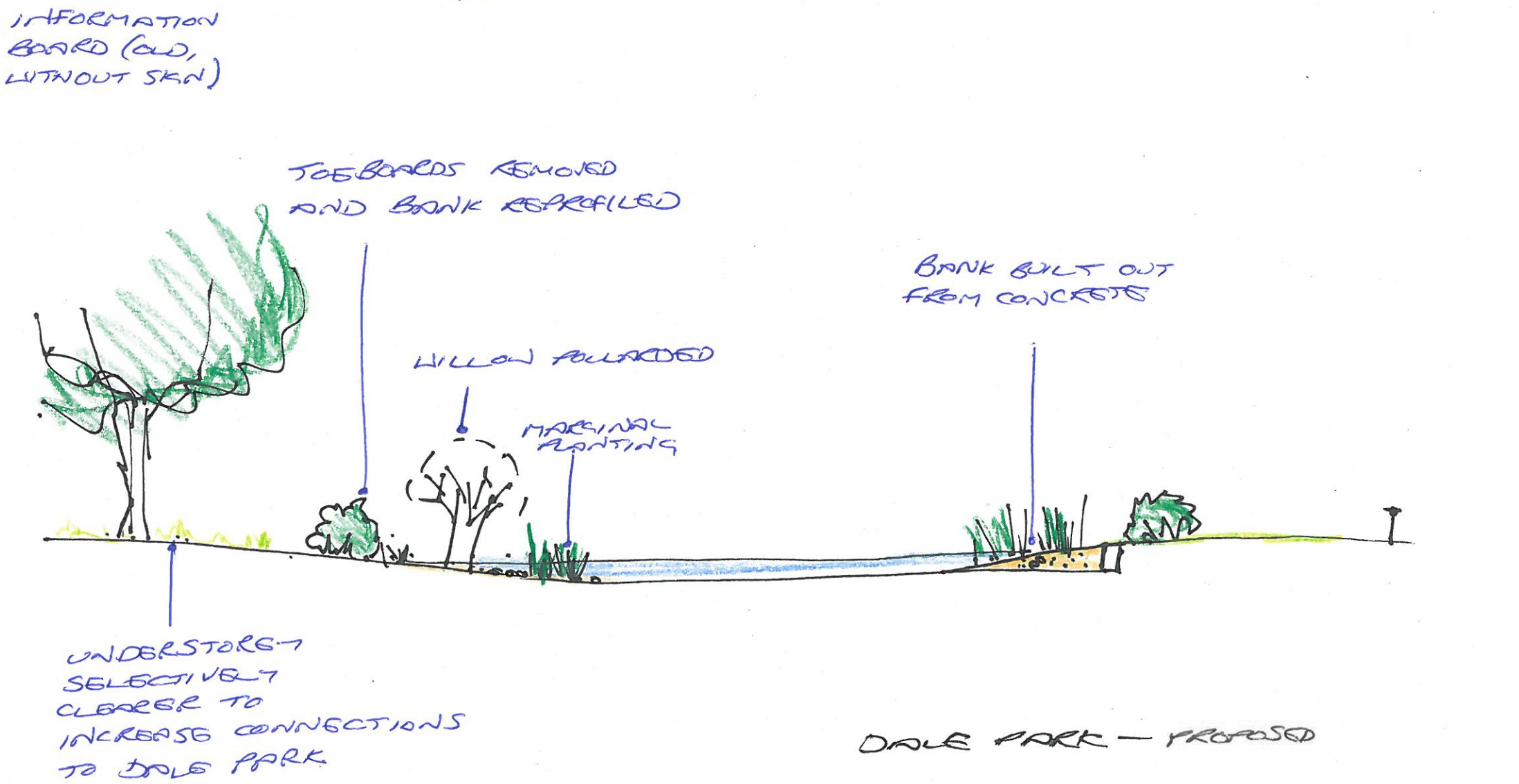
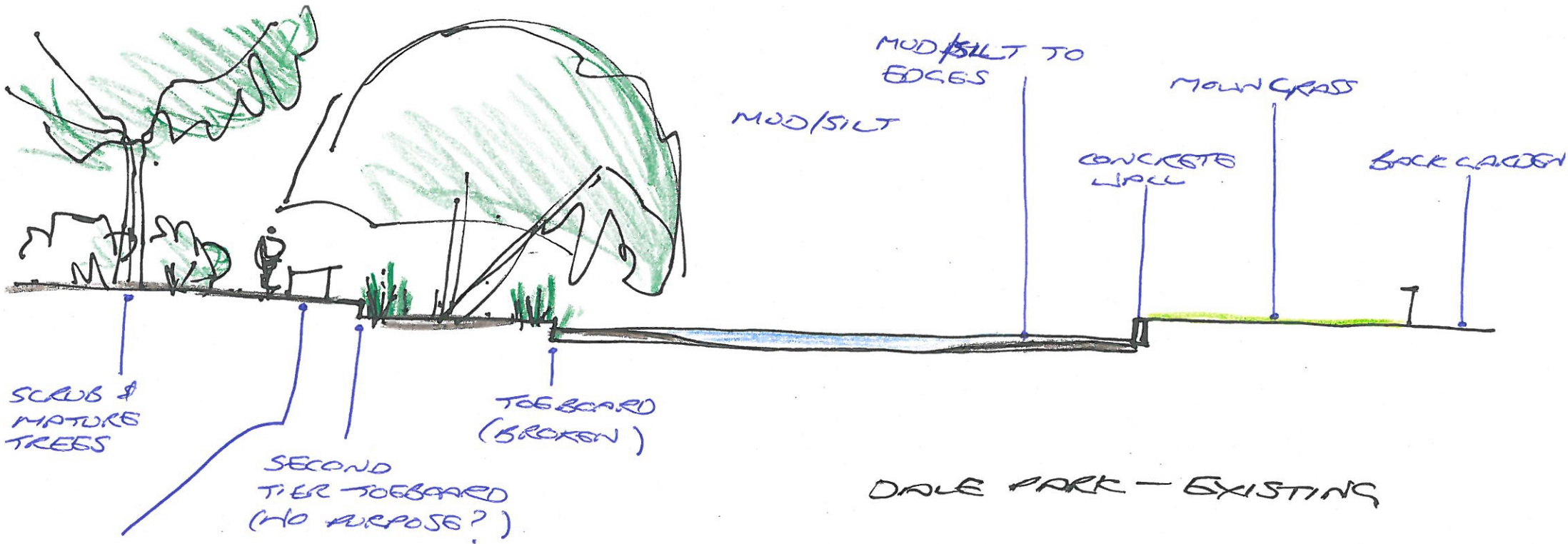

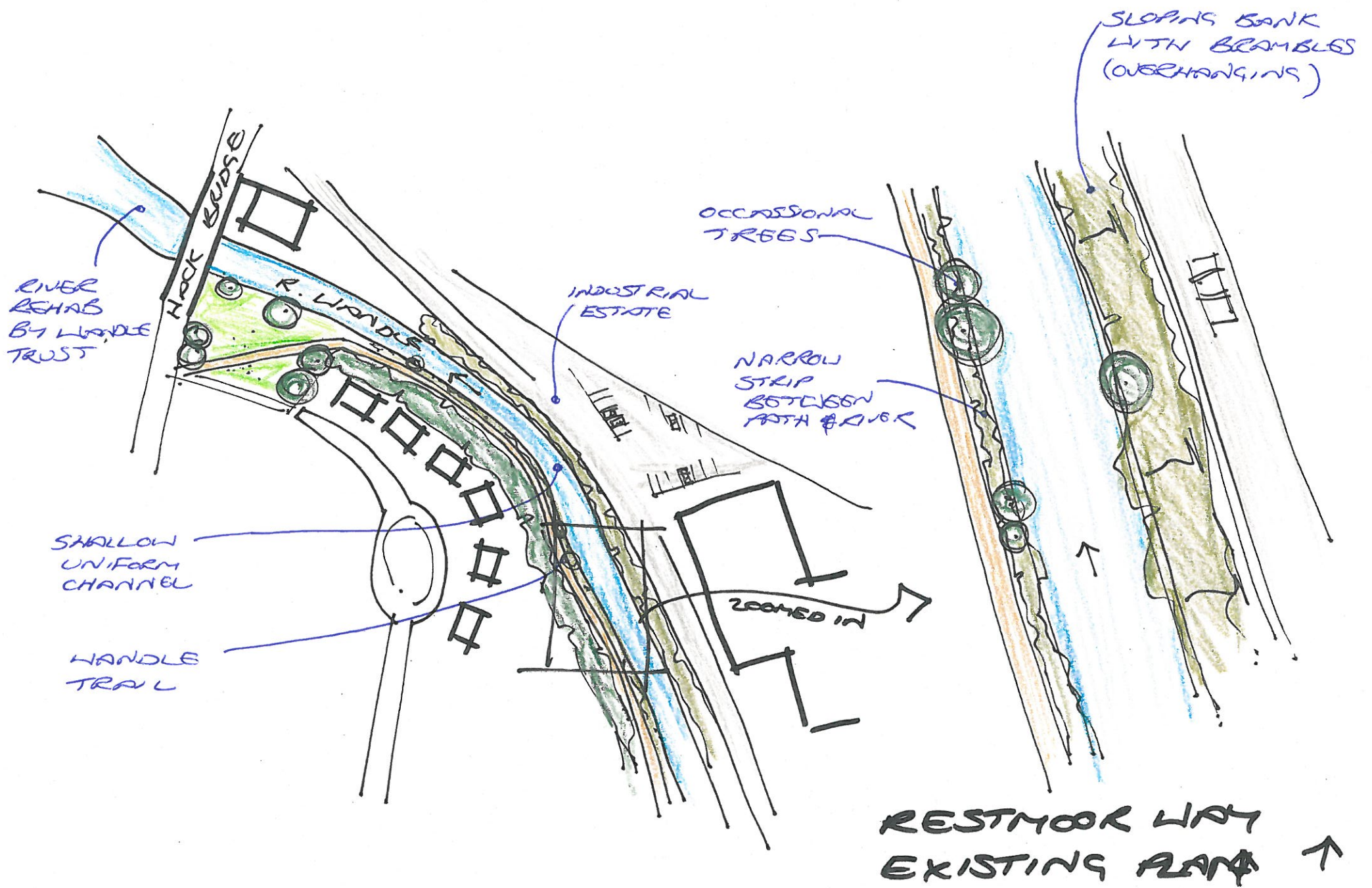

IN-CHANNEL
MODIFICATION
ALLOWS BANK
TO BE REPROFILED
(NICOSPAN)

IN-CHANNEL
PLANTING

EXISTING
VEGETATION
SELECTIVELY
CLEARED

GRAVEL ADDED
TO BED

IN-CHANNEL
MODIFICATION
(FAGGOT BUNDLES)

RETAIN
SOME
EXISTING
OVERHANGING
VEGETATION

LWM could be
added instead of
building out banks
in places

RESTMOR WAY
PROPOSED PLAN

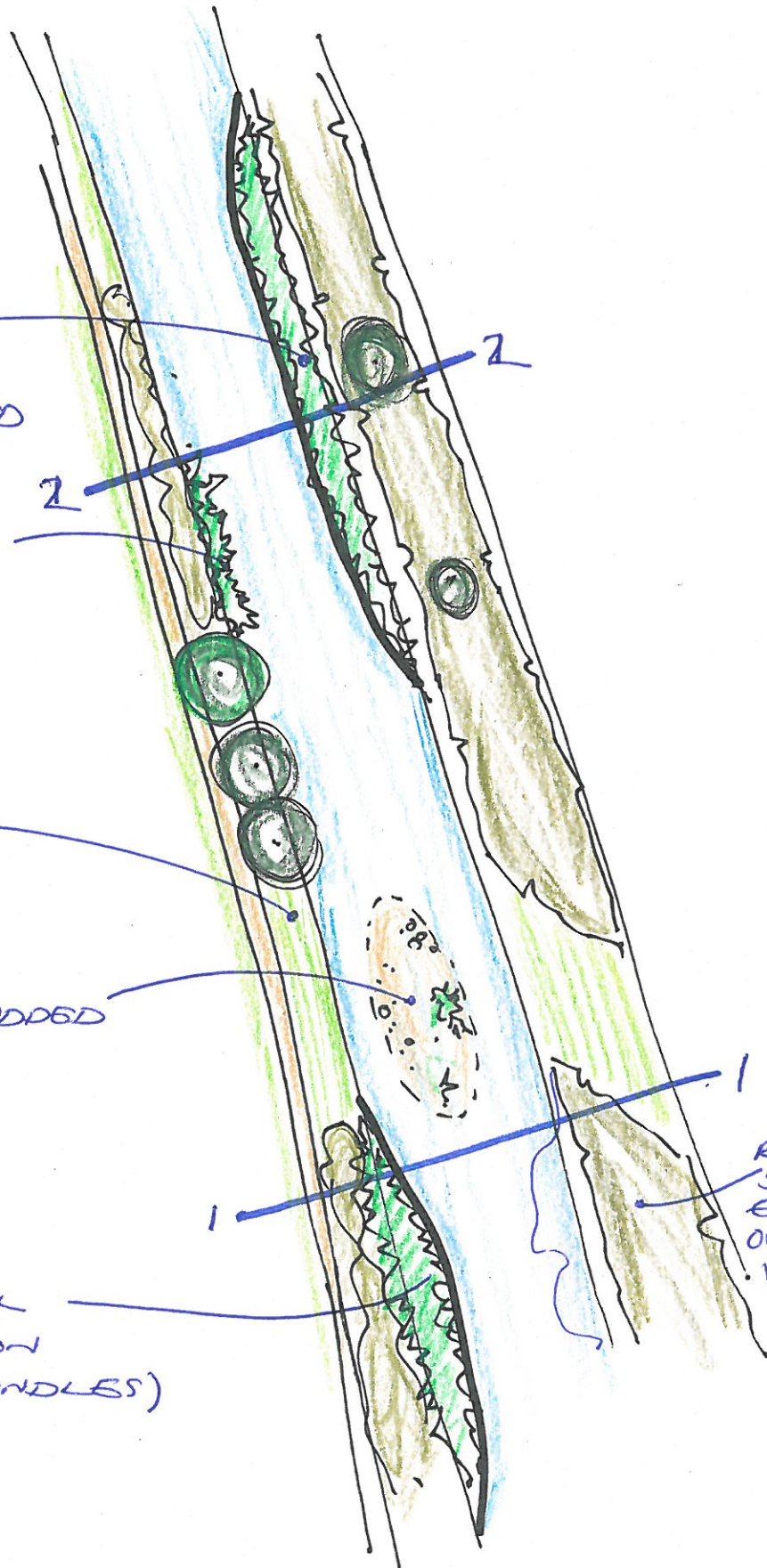

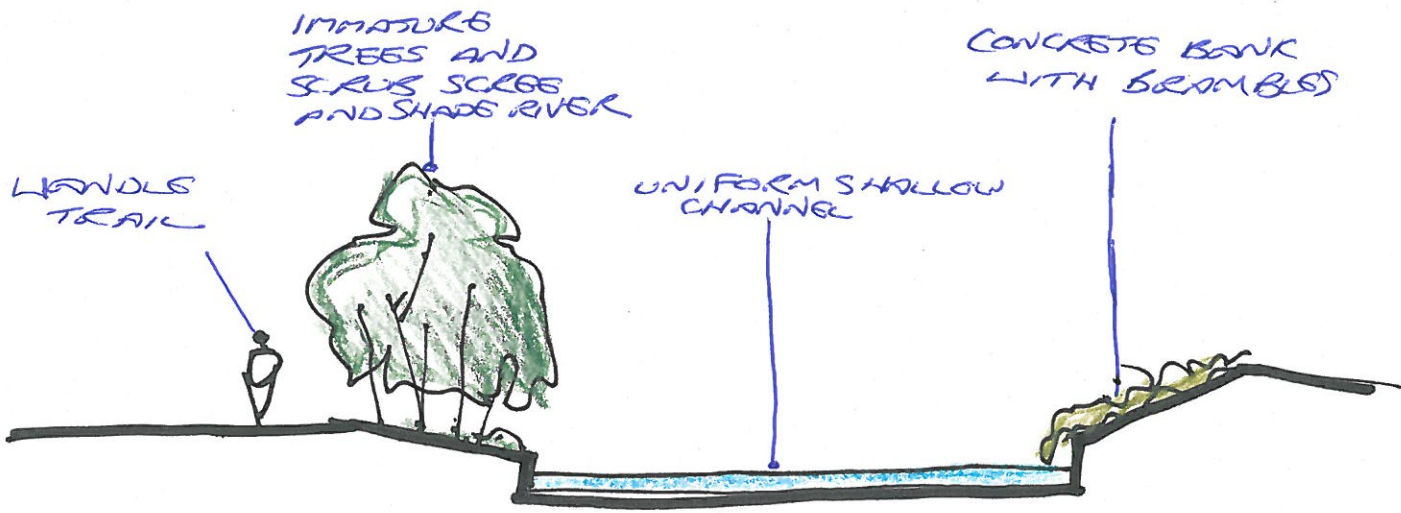

EXISTING PROFILE

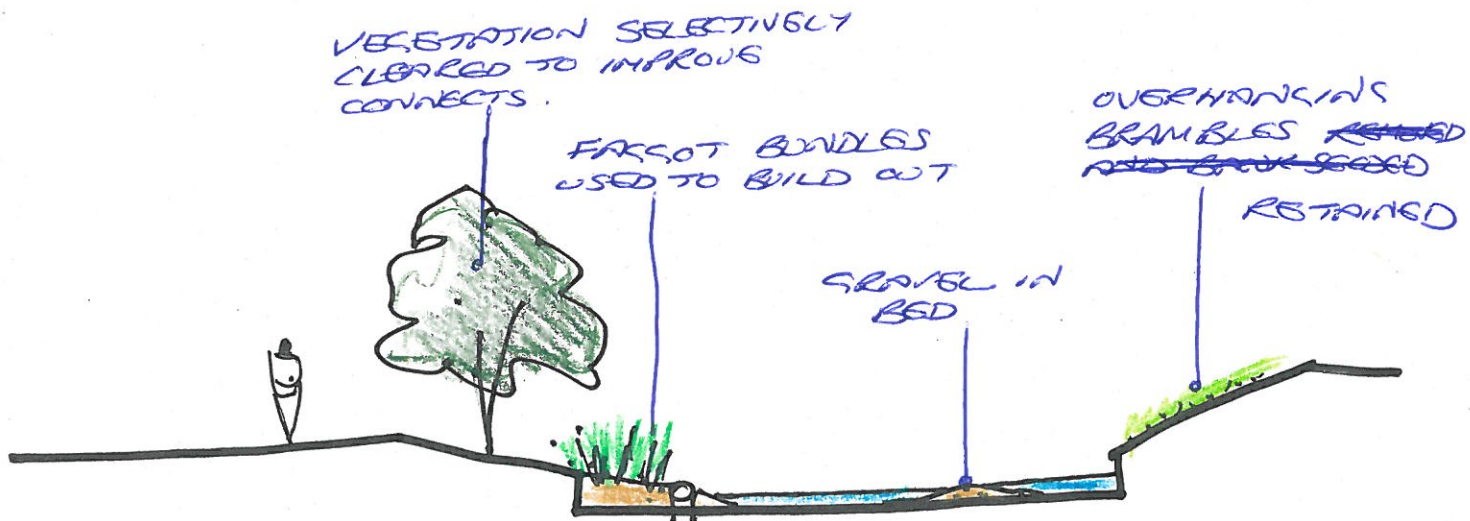

PROPOSED PROFILE 1.

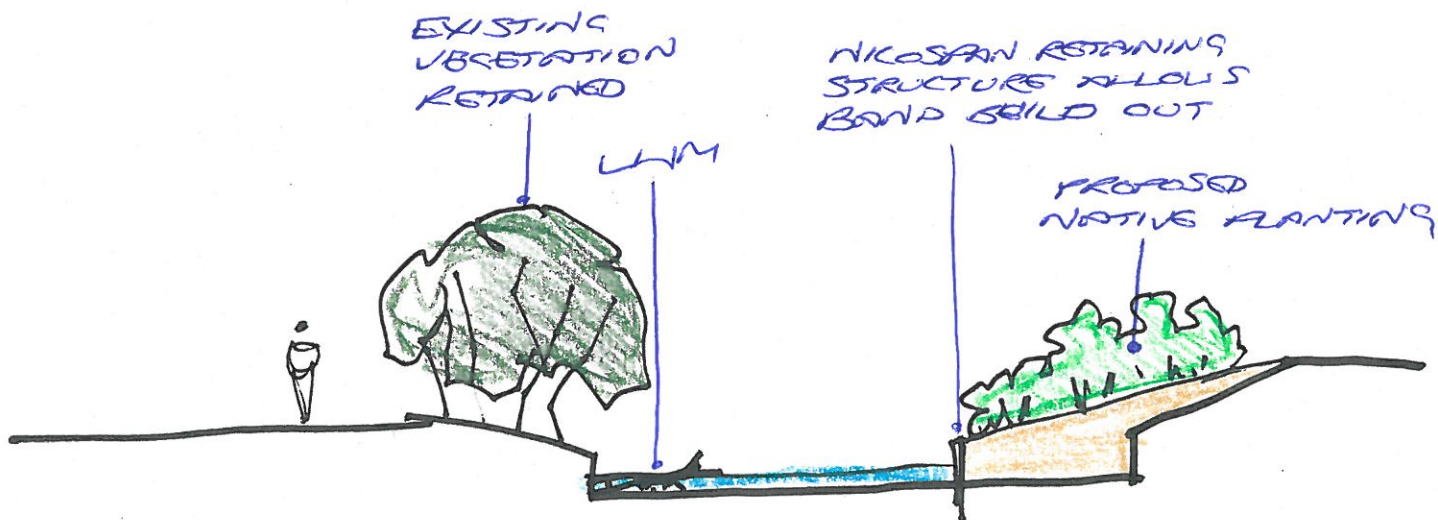

PROPOSED PROFILE 2.

RESTROOM WAY